

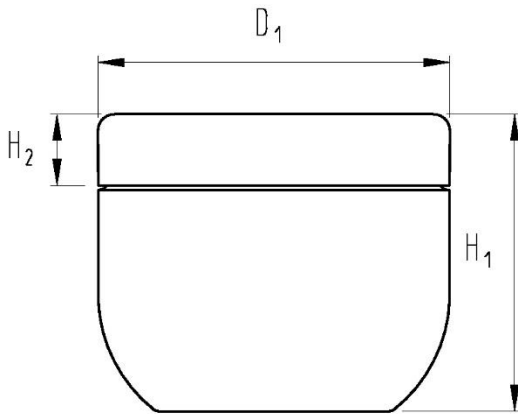

DATA SPECIFICATION - NEW LINE



- MATERIAL:** Polypropylene (PP) / Polyethylene (PE)
food safe
- COLOUR:** Standard colour white or transparent
any colour combinations possible
- SURFACE:** Bottom translucent respectively muted matt (m),
partly glossy (g)
cap matt (m) or glossy (g)
- DECORATION:** screen printing / pad printing / lable
- CHARACTERISTICS:** - single walled
- suitable for solid, pasty or viscous fillings
- sealable
- sealing washer
- flyers and folder are insertable
- PRICE:** on inquiry

Size	Description	Volume ml	Ø D ₁	H ₁	H ₂	Surface	
						bottom	cap
5001	Screw Container NEW LINE	10	32	7	26	m	m / g
5002	Screw Container NEW LINE	20	39	32	8	m	m
5004	Screw Container NEW LINE	30	45	9	37	m	m / g
5005	Screw Container NEW LINE	50	53	12	44	m	m / g
5010	Screw Container NEW LINE	100	62	13	53	m	m / g
5015	Screw Container NEW LINE	150	68	13	57	m	m / g
5020	Screw Container NEW LINE	200	81	17	60	m / g	m / g
5025	Screw Container NEW LINE	250	81	17	68	m / g	m / g
5030	Screw Container NEW LINE	300	88	18	74	m / g	m / g
5050	Screw Container NEW LINE	500	102	20	85	m / g	m / g
5100	Screw Container NEW LINE	1000	116	24	130	m / g	m / g
5125	Screw Container NEW LINE	1250	116	24	150	m	m / g

Sealing washer	Suitable for size	Sealing washer	Suitable for size
5002/00-DE-0000	5002	5025/00-DE-0000	5020 5025
5004/00-DE-0000	5004	5030/00-DE-0000	5030
5005/00-DE-0000	5005	5050/00-DE-0000	5050
5010/00-DE-0000	5010	5125/00-DE-0000	5100 5125
5015/00-DE-0000	5015		



Dimensions for lables (maximum dimensions) mm

Bottom

Size	Height label	scope up slightly conical *)	scope below slightly conical *)	Ø Label underside
5001	8	99	98	17
5002	10	122	121	20
5004	11	138	136	23
5005	14	162	160	28
5010	18	195	193	34
5015	20	209	207	37
5020	20	251	250	41
5025	23	251	249	41
5030	24	273	270	47
5050	29	314	311	56
5100	65	360	354	62
5125	83	360	352	62

Cap

Size	Height label *)	Length label *)	Ø Label top
5001	3,5	100	26
5002	5,0	121	31
5004	6,5	138	40
5005	7,0	162	43
5010	8,5	195	54
5015	9,5	209	60
5020 / 5025	11,5	251	70
5030	12,5	273	77
5050	15,0	314	88
5100 / 5125	16,5	358	100

*) Contact your label manufacturer for optimal adjustment